



Welcome to

**DECATUR
CITY
CHURCH**

BUILDING MAP

Floor
3

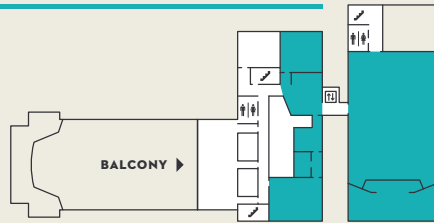

Floor
2



Floor
1

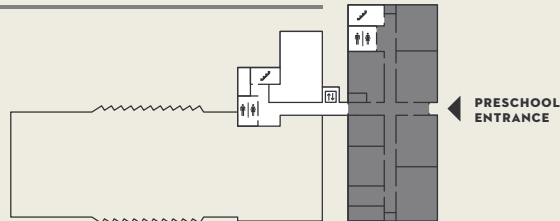

● PRESCHOOL ● ELEMENTARY ● MIDDLE & HIGH SCHOOL

Welcome

In May 2018, Dr. Jim Haskell, lead pastor of Bridgepoint Church at Toco Hills, approached Decatur City about leasing a portion of its space. Bridgepoint (formerly Clairmont Hills Baptist Church) owns this 60,000 square foot building on the corner of one of the busiest intersections on the eastside of Atlanta. However, in recent years, over 75 percent of the building had been unusable due to the mounting cost of needed HVAC repairs and other deferred maintenance.

Bridgepoint faced the choice of selling to a developer who would tear the building down or finding someone who could invest in making an old building new again. In July 2018, Decatur City Church signed a multi-year lease for about 50,000 square feet of the building and began the process of refreshing the space.

After over four years of setting up and tearing down each week and six months of an intense renovation and redesign project, Decatur City launched in its first nonportable home on Sunday, January 27, 2019.



MAIN ENTRANCE LOBBY

The main entrance lobby is where the majority of our guests enter on Sunday mornings. From this space you can easily navigate toward all of our major environments.

The yellow awning outside is designed to be a landmark for guests and their friends. "Enter under the yellow awning" has been the perfect directional statement to help people navigate between the two different church entrances that face the parking lot. As our only use of yellow on the exterior of the building, it's the perfect pop of color to help them get to the right place.

This space also highlights some of the hand-painted signage that is used throughout the building. As we tried to figure out how to help people get around an old space that was built in stages and difficult to navigate, we looked to places like Ponce City Market for inspiration. Designed in-house and painted by local artist Courtney Myers, this whimsical approach to wayfinding was a fun way to solve a complicated problem.



Before



After



FIRST-TIME FAMILY CHECK-IN

Attached to the lobby is our new first-time family check-in space. When a family attends Decatur City for the first time, this room is their one-stop shop to check in all of their kids from preschool to middle school and to be escorted to the correct environments.

One of the challenges we faced in this building was the lack of Guest Services space available for our family environments, and an old media center off the main lobby provided the perfect solution. We're excited about this innovative way to streamline the guest experience!

Before



After



UPSTREET

UpStreet is our environment for kids in kindergarten through fifth grade. We currently have three classrooms, divided by age, with one large group space designed for energetic worship and a weekly Bible story.

One of the unique challenges we faced with this space was that because this is one of the main thoroughfares in the building, the hallway needed to be shared by adults and kids. The mural you see is the solution to that problem. It was originally hand-drawn by local designer Colin Harman and painted by Courtney Myers. With local Decatur buildings in the foreground and downtown Atlanta landmarks in the background, there's something fun for attendees of any age to discover!



Before



After



AUDITORIUM LOBBY

This second lobby space is home to our main Guest Services area and is a great place to gather with friends before and after the service. It also features our Decatur City stained glass logo. This piece was crafted by a local artist as part of the public announcement of our move and a nod to the old church building we would be restoring.

Along the back wall of the lobby is a Starting Point room—our first-ever dedicated space for people who want to explore conversations about faith. We love seeing this space used to create a safe and welcoming environment for people to ask some of life's toughest questions.

This lobby is also how you can access the auditorium balcony when it's open. It has a dedicated stairwell on the south side of the building.

Before



After



AUDITORIUM

Our biggest priority in the auditorium update was to embrace the rich history of this room and honor the legacy of so many who have invested in this space over the years. We took inspiration from The Tabernacle in Atlanta and the Ryman Auditorium in Nashville—both destination venues with high-quality production that also embrace the history of their location.

- As a way of honoring the unique history of the space, we reupholstered the pews, kept the stained glass, and exposed parts the original pipe organ behind the stage.
- We kept the organ functional and the console sits behind one of the front stage walls on a lift so it could be raised when in use. Some of the pipes that were installed in the 1970s were repurposed from previous churches and date back to the 1850s.
- The auditorium seats approximately 680 people: about 540 on the main floor and about 140 in the balcony.

Before



After



THE ATTIC

The Attic is home to our middle school and high school students. Transit and InsideOut, our student environments, split the room into an interactive pre-function space and a dynamic production space. They also have a suite of small group rooms to meet in for group discussions each week.

This space was designed with flexibility in mind and will be host to many different events and environments during our time here. The mural on the back wall was designed by Ben Ackerley, a member of our building team, to mimic the iconic geometric art around Krog Street and the Beltline. It was painted by local artist Julie McKeivitt.

Before



After

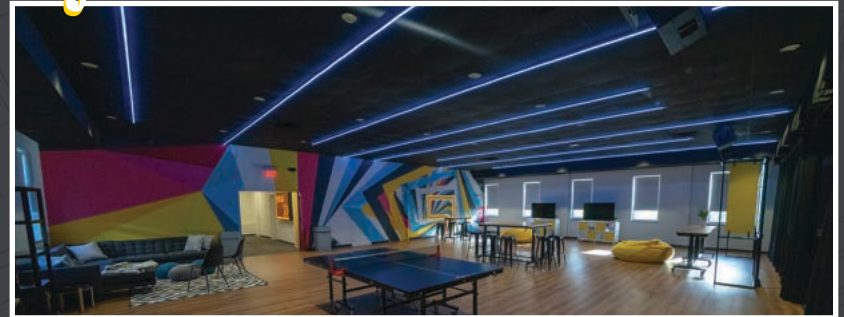

WAUMBA LAND

Waumba Land is the space for our smallest attendees (6-weeks through Pre-K). We have seven Waumba Land classrooms separated by age, one of which doubles as a large group space for our older children to gather each week to sing, dance, and learn.

One of the best features in Waumba Land is its dedicated exterior entrance. Attendees with preschoolers can simply park in our reserved preschool parking lot and enter directly into Waumba Land to drop off their children.

Painted by local artist Lindsay Ryden, the cloud mural on the hall serves as the backdrop for bright, interactive displays.

Before



After



**1995 CLAIRMONT ROAD
DECATUR, GEORGIA 30033**



DECATURCITY.ORG

